

# GODREJ AVENUES

YELAHANKA, BENGALURU

# HAPPINESS IS A PLACE CALLED HOME

---

Presenting Godrej Avenues, homes that keep you  
happy every day.





# STAY CONNECTED TO HAPPINESS

Godrej Avenues offers you excellent connectivity to every important hub in Bengaluru.



## Road

Enjoy easy access to Outer Ring Road, Yelahanka-Doddaballapur Highway and the International Airport Road



## Air

The International Airport Road from Yelahanka takes you straight to the International Airport in 35 minutes



## Rail

Yelahanka Railway Station - 15 mins  
Hebbal Railway Station - 25 mins

## SOCIAL INFRASTRUCTURE



### Schools

National Public School | Mallya Aditi International School  
Canadian International School | Euro Kids



### Colleges and Technical Institutions

BMS Institute of Technology | Sir M. Visvesvaraya Institute of Technology  
Presidency College | Srishti School of Art, Design and Technology



### Healthcare

Apple Hospital | Aster CMI Hospital | Baptist Hospital  
Columbia Asia Hospital | Malavya Hospital



### Leisure and Entertainment

Esteem Mall, Hebbal | Chairman's Club Resort  
Elements Mall, Thanisandra



### Commercial

RMZ Galleria | NCC Urban | Manyata Tech Park  
Kirloskar Tech Park | World Trade Centre

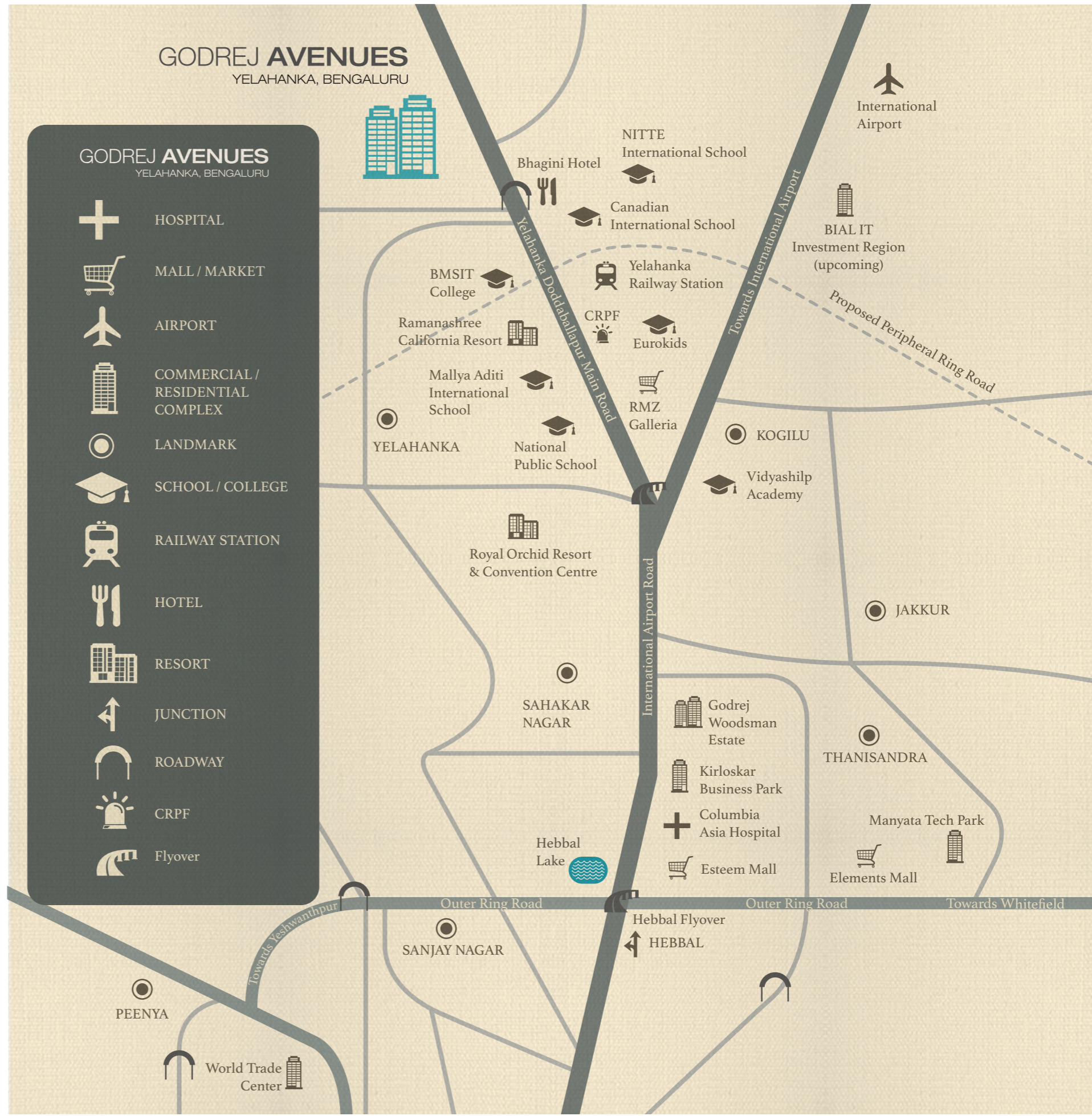



# MASTER LAYOUT



- EN Main Gate
- CD Clubhouse Dropoff
- CB Clubhouse
- SP Swimming Pool
- CP Children's play area
- LM Landscape mound
- WF Water feature
- BT Bicycle track
- WJ Walking / Jogging track on the Ground
- CP Cricket pitch
- GP Golf Putting
- VP Visitors' Car Park
- YG Yoga deck on the Ground
- BER Basement Entry Ramp
- BER Basement Exit Ramp
- LT Landscape throughway
- MHD Multipurpose Hall Deck
- LW Lawns
- SA Stargazing area on the terrace
- WP Walking pathway on the terrace
- BAR Barbeque area on the terrace
- ZG Zen Garden on the terrace
- ST Seating on the terrace
- RC Reflexology court on the terrace
- YD Yoga deck on the terrace
- SBS School bus stop
- CA Civic Amenities Site
- PA Park Area

TOWARDS YELAHANKA

YELAHANKA - DODDABALLAPUR MAIN ROAD

TOWARDS DODDABALLAPUR





## DELIGHTFUL LIVING SPACES

---

The interiors of your home are a fine blend of space and elegance. With expansive living areas, **large balconies** and **exclusive lobby area**, residences at Godrej Avenues are **Vastu-compliant, well-ventilated and naturally lit.**



## A RELAXING WORKSPACE

---

Discover the comfort of working from home with high speed **Wi-Fi connectivity** and hi-tech workplace amenities – including **Video Conferencing facility**.







## LIVE BLISSFULLY SECURED 24x7

---

Be assured of your family's safety and well-being with the 3-tier security system at Godrej Avenues. **Video Door Phones, CCTV Surveillance** and a **24x7 security service** will always keep your loved ones protected.





## CLUB AVENUES

---

Club Avenues, the exclusive **20,000 sq.ft.** clubhouse at Godrej Avenues has state-of-the-art facilities for you to make the best of your leisure time. Get refreshed with a dip in the **pool** or enjoy a workout session at the **gymnasium**. Here, you can choose to unwind the way you like.



POOL TABLE



CARROM, CARDS,  
CHECKERS AND CHESS



FOOSBALL AND  
GAMING ARCADE



DART BOARDS AND  
SKIPPING AREA





MINI THEATRE



DANCE AND MUSIC ROOM



KIDS PLAY AREA



INDOOR BADMINTON COURT





# SKY LOUNGE AT 150 FEET



## Walking Track

Start your day with a walk amidst the clouds at 150 feet.



## Zen Garden

Lose yourself in the peace and calm of the Zen Garden.



## Yoga and Meditation Zone

Rediscover a fitter and better you every day.



## Star Gazing Area

Watch a shooting star with your loved ones and make your wish come true.



## Al Fresco Barbeque Area

Surprise your loved ones with a special barbeque treat.



## Acupressure Pathway

Energize yourself with a walk that touches all the right points and leaves you refreshed.



## Reflexology Court

The ancient art of reflexology will soothe you with a walk on the pebble trail at the reflexology court.





# EXPERIENCE THE HIGH LIFE AT 150 FEET

GODREJ **AVENUES**  
YELAHANKA, BENGALURU

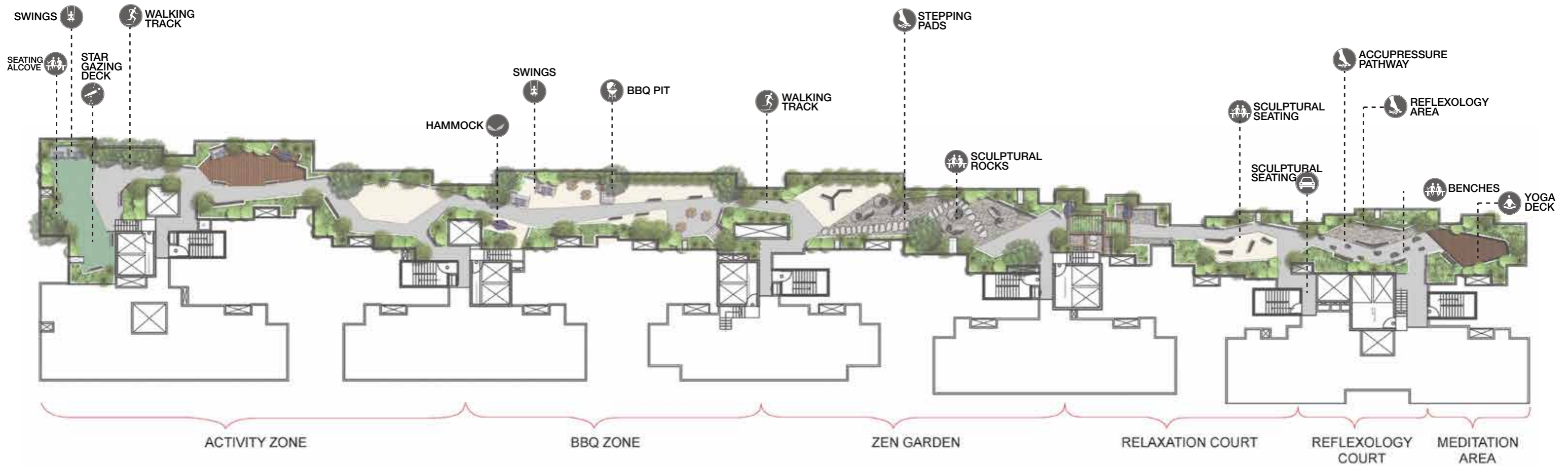





## A SERENE LANDSCAPE

---

At Godrej Avenues, the exteriors of your home are as well-designed as the interiors. Your neighbourhood is dotted with **open spaces**, landscaped gardens and walkways. The central park, with its **modern sculptures**, fountains and **water bodies**, will always make your time outdoors a tranquil one.





## APOLLO PHARMACY

---

Asia's largest Healthcare Group, Apollo is bringing their Pharmacy services in your residential community to cater to your medical needs.



A close-up photograph of a woman with long brown hair, smiling warmly. She is wearing a white lab coat over a light blue button-down shirt. A blue stethoscope is draped around her neck. She is also wearing a black headset with a microphone. Her right hand is raised to her ear, adjusting the headset. The background is a soft, out-of-focus blue and white pattern, possibly representing a window with blinds or a clean clinical setting.

## APOLLO TELE-MEDICINE

Apollo Tele-medicine will provide consultation and real time services using point of care devices, for around 20 kinds of diagnostics tests. This facility will provide the best available health-care for all residents in the community.





## EVERY CONVENIENCE BY YOUR SIDE

A one-stop destination at your doorstep for all your daily grocery needs with Nilgiri's Supermarket





## UNVEIL THE ARTISTE IN YOU

---

Learn to play your favourite musical instrument at the  
Eardrums Music Hub.





## JUST BOOKS

---

The library setup by **JustBooks** is a hub for book lovers of all ages to sit back and enjoy a collection of books in every category you desire.





## GO PRO

---

Now learn to play cricket like a true professional with dedicated coaching sessions by the **Just Cricket Coaching Academy** or stay fit with daily workout sessions at the state-of-the-art gymnasium.



## PRODUCT DETAILS

---

GODREJ **AVENUES**  
YELAHANKA, BENGALURU

TYOLOGY	SQ.FT.
1 BHK	629-706
2 BHK	1023-1260
2.5 BHK	1390-1398
3 BHK	1446-1721



# SPECIFICATIONS

Structure	Type of structure	Mivan	Your home is built with the help of a Mivan structure system, a technology which uses aluminium framework and reinforced concrete. This ensures high durability, minimal leakages and low maintenance cost.
Flooring	Living/ Dining	Vitrified tiles	Carefully handpicked flooring tiles add aesthetic beauty to your living space. Vitrified tiles are chosen for the living and dining room as they are easy to maintain, durable and better performing compared to other flooring material.
	Other bedrooms		
	Master bedroom	Wooden laminate	Your master bedroom is elegantly crafted with wooden laminate flooring, a relatively new invention which has taken the world of floor surface as it is aesthetic, offers durability and is easy maintenance.
	Toilets	Anti Skid Ceramic tiles	Areas prone to wet surface are glamorized with antiskid ceramic tiles which prevent injuries caused by slips, trips & falls
	Balconies		
	Utility		
	Kitchen	Ceramic tiles	Relish every minute of your time cooking for your loved ones! Usage of environment friendly ceramic tiles in your kitchen ensures easy and quick cleaning. These tiles are antistatic in nature.
Doors	Main door	Teak Frame with hardwood flush shutter with teak veneer two side polish	Exceptionally strong and durable, teak lasts a lifetime in a wide range of climates. High oil and rubber content gives it weatherproof qualities. Teak requires no preservatives or paint. Above all it is renewable and an eco-friendly resource.
	Internal doors	Wooden door frame with flush door shutter	Enjoy the warmth inside your home. Every internal door is made of wood, a natural insulator of heat that is not affected by temperature. Unlike metal doors, wood requires less maintenance and are rust proof.
Windows	Aluminium	Aluminum windows with track for mesh	Aluminium windows and doors contribute to excellent thermal and sound insulation which meets current building regulations. Unlike many other windows and doors, they will not swell, crack, split or warp over the time and ensures an extended life.
Wall and ceiling	Paint	OBD	Oil based distemper paint is an environment-friendly paint which does not have any hazardous elements in its composition. A sleek matt finish makes you revel in the look and feel of your dream home
Kitchen and utility	Kitchen counter and sink provision	Granite counter with SS sink	Your kitchen is adorned with a natural product having a timeless aura and appeal. Granite being a heat resistant material is a perfect cooktop. The various minerals within granite add depth and character making every granite top unique.
Toilet	CP Sanitary brand/ selection	Hindware/Jaquar or equivalent	Beautiful designs that inspire are chosen for your bathing suites which compliment your lifestyle
Power	Power allotted to flat	1 BHK-2.5 KW, 2 BHK-3 KW, 3 BHK-4 KW	Adequate power is supplied as per the standard requirement
Balcony railings	Railing	MS railing	We believe in keeping you safe. When it comes to handrails, it is important to use a durable and strong material considering the safety aspect. One of the most easy to maintain materials, also aesthetically appealing. Mild steel is no doubt a time tested material used for ages in construction.
Car parking type	Open/covered	Covered carpark	Every apartment is allotted a covered car park positioned in the basement.
Power Backup	DG backup to flat	1 BHK- 0.75 KW 2, 2.5, 3 BHK - 1 KW	Enjoy uninterrupted power supply at any point of time. Adequate power backup is supplied which is rich enough power to light up your house.
Reticulated piped gas system	Piped gas	Reticulated piped gas system	A convenient value adding feature promises an uninterrupted supply of cooking gas direct to the hotplates This system of piped gas saves your time, space and money.



# GODREJ AVENUES

## YELAHANKA, BENGALURU

 **1-800-258-2588** |  **GODREJ AV to 56070** | **Email: [avenues@godrejproperties.com](mailto:avenues@godrejproperties.com)**

**Site Location:** Godrej Avenues, Yelahanka – Doddaballapur Main Road, Near BMS Institute of Technology, Yelahanka, Bengaluru – 560089.

**Disclaimer:** This is not an offer, invitation to offer and/or commitment of any nature. The Tie-ups, layout, plans, specifications and other details herein are only indicative and are subject to change without notice. The artist's impressions are for illustrative purpose. T&C apply